

RE-104

FIRE ALARM CONTROL PANEL

General

RE-104 is a right blend of affordable design and quality with latest technology for fire alarm control panels. This microprocessor based conventional Fire Alarm Control panel, is designed for small size commercial buildings and small scale industries. RE-104 model is a user friendly 4 zone standalone control panel, with optional zone wise Sounder/Contact respectively.



Special Features

- Switched Mode Power Supply.
- Modular Construction, Serviceable.
- Surface Mount Technology.
- Battery polarity & deep discharge protection.
- Programmable Keypad lock

Features

- Complies IS -15908: 2011 Standard.
- 16 X 2 Dot Matrix LCD Display.
- Standby battery backup with built in charging.
- Fire / Fault status in unambiguous colored LED indication.
- Switch Mode Power Supply.
- Tactile Keypad for easy panel operation.
- System ON indication.
- Main, Standby status indication.
- Low Battery visual warning with audible tone.
- Relay output for actuators, for Fire and Fault.
- Lamp Test facility.
- Zone wise one man Walk Test Facility.
- Zone wise Isolation facility with loop voltage cut off.
- Compatible to all type of Conventional Detectors.
- Optional Zone Wise Sounder / Zone Wise Contact.

Specification

| Electrical Specification | |
|--|---|
| Primary Power | 120 / 220VAC + 10% -15%, 60 / 50 Hz. 100W |
| Standby Power | 24VDC (2 Nos of 12V, 7Ah Sealed Lead acid battery) |
| Operating Condition | Operating Temperature 0 – 49° C / 32 – 120° F. Storage Temperature 0 – 60° C Relative Humidity 93 ± 2% RH (non-condensing) at 32 ± 2° C / 90 ± 3° F |
| Quiescent Current | 55 mA. |
| Charging Circuit | Charging voltage 28 V, ± 2% Charging current 0.5A (max) |
| Notification Appliance Circuits | Wiring style Class B Operating voltage 24VDC nominal Current 0.6A EOL resistor 4K7, ¼ watt |
| Relays | Type Form C Quantity 3 No's Relay contact rating 2Amps @ 30 VDC; 0.5A @ 125 VAC Power factor 1.0 |
| Initiating Device Circuits | Wiring style Class B Quantity 1 No Normal operating voltage 14 – 21 VDC Alarm current 15 – 30 mA Short circuit current 42 mA (max) Loop resistance 50 Ω (max) EOL Resistor 4K7, ¼ watt Standby current 6.8 mA (2.4 mA for detectors) |
| Mechanical Specification | |
| Dimensions | 350W X 250H X 100D |
| Color | Red / White |
| Construction | 18 Gauge (1.22mm) CRCA sheet with powder-coated finish |
| IP Rating | IP50 |
| Cable Entry | 8xØ19mm Knockout on top of the cabinet |

Dimensions

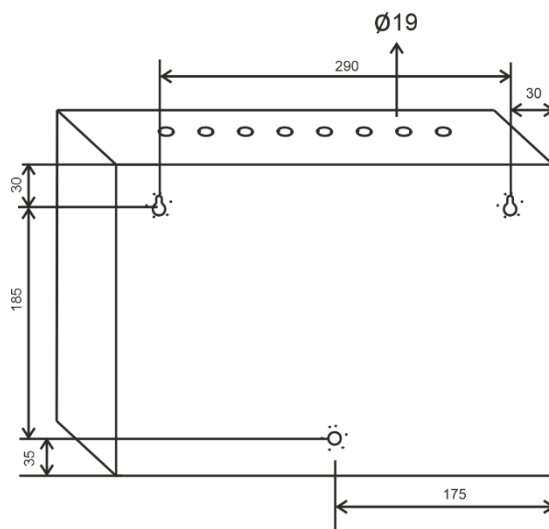

Note:- All Dimensions are in mm

Wiring Configuration

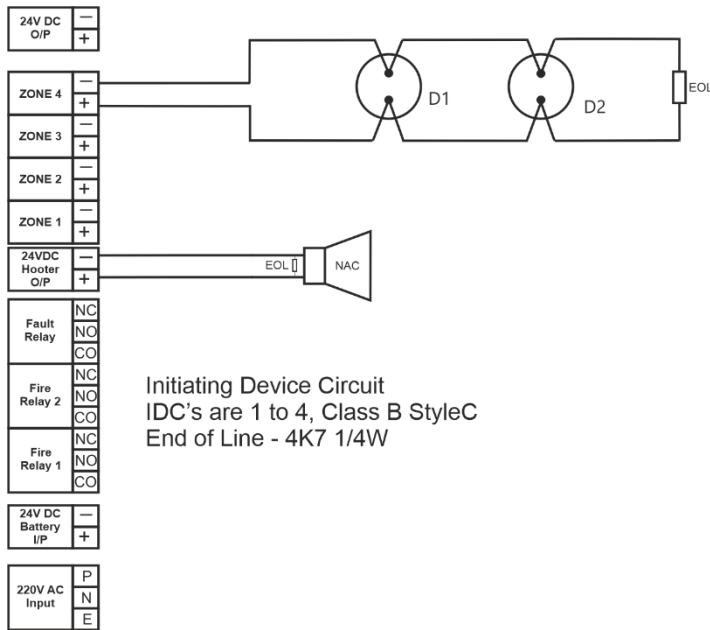

Compatible Devices

| Models | Description |
|--------------------|---|
| <i>RE-316S-2L</i> | Photoelectric Smoke detector with base. |
| <i>RE-316H-2L</i> | Heat detector with base. |
| <i>RE-316SH-2L</i> | Photoelectric & Heat detector with base |
| <i>RE-716 MR</i> | Conventional Manual Call Point. |
| <i>RE-24 CS</i> | Conventional Sounder. |

Ordering Information

| Models | Description |
|----------|---------------------------------|
| RE-104-W | 4 Zone Fire Alarm Panel (White) |
| RE-104-R | 4 Zone Fire Alarm Panel (Red) |

India

RAVEL ELECTRONICS PVT LTD.,
150A, Electronics Industrial Estate,
Perungudi, Chennai – 96, India.
E-mail: marketing@ravelfire.com; Web: www.ravelfire.com

United Kingdom

RAVEL ELECTRONICS LTD.,
Unit 11, Chancel Industrial Estate, Newhall street,
Willenhall WV13 1NX, West Midlands, United Kingdom.
E-mail: info@ravelfire.co.uk; Web: www.ravelfire.co.uk

USA

RAVEL AMERICAS INC.,
2855 NW 112th Ave ST#2 Miami,
Doral, Florida 33172, USA.